

Now in Fairfield Township Crawford County
Peter Lohra

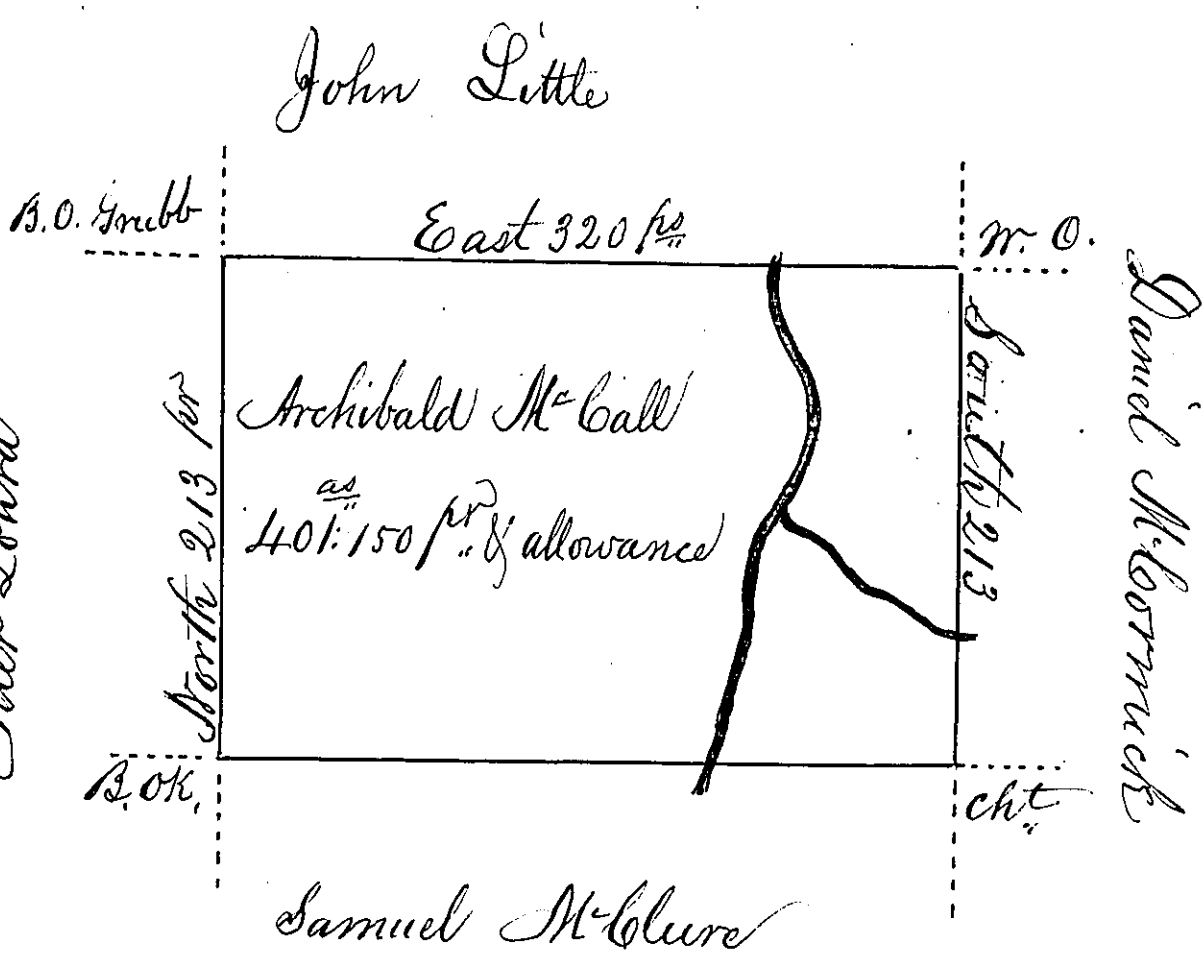

Situate on the West side of French Creek in Allegheny County, containing 401^{ac} & 150 p^{rs} & allowance of six per cent for roads &c. Surveyed the 7th day of November 1794. In pursuance of a warrant dated the 13th day of April 1792.
To Daniel Brodhead Esqr. & Wm Power Esqr.
Surveyor General

IN TESTIMONY that the above is a copy of the original remaining on file in the Department of Internal Affairs of Pennsylvania, made conformably to an Act of Assembly approved the 16th day of February, 1833, I have hereunto set my Hand and caused the Seal of said Department to be affixed at Harrisburg, this

Twenty eighth day of January 1883.

J. Simpson Africa,
Secretary of Internal Affairs.